

# Nintendo DSi Quick-Start Guide



This guide takes you through the procedures used to configure the system, including a step by step guide on how to start the software. It also gives an overview of the basic features of this system.

**Important:** Be sure to read the Health and Safety Precautions Booklet and Nintendo DSi™ Operations Manual before use, and follow the instructions carefully. In cases where a small child will be using the system, a parent or guardian should configure the System Settings for them.

C/TWL-UKV

## 1. Configure the system!



Before using any software, you have to configure the system. Configure the settings by following the step by step guide shown below. (All of the screenshots show the lower screen.)

### No power?

Refer to the Nintendo DSi Operations Manual for information on charging the battery.

→ Nintendo DSi Operation Manual – Basics – Charging the Nintendo DSi Rechargeable Battery Pak



### 1 Turn the power on

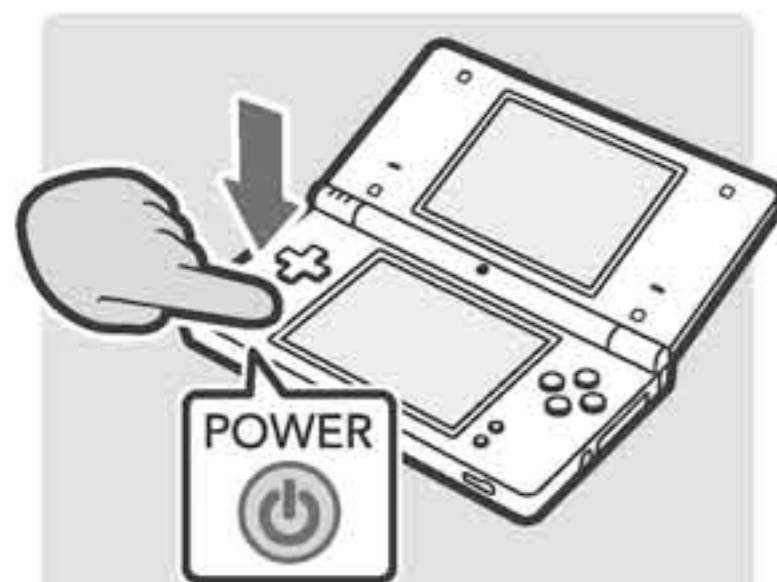

Press the POWER Button

**Note:** Remove the stylus from the side of the system and use it to perform all the following steps.

### 2 Configure the System Settings



Touch **OK**

### 3 Choose language and country



Touch your language.

Touch **OK**



Touch your country of residence.

Touch **OK**

### 4 Set the date

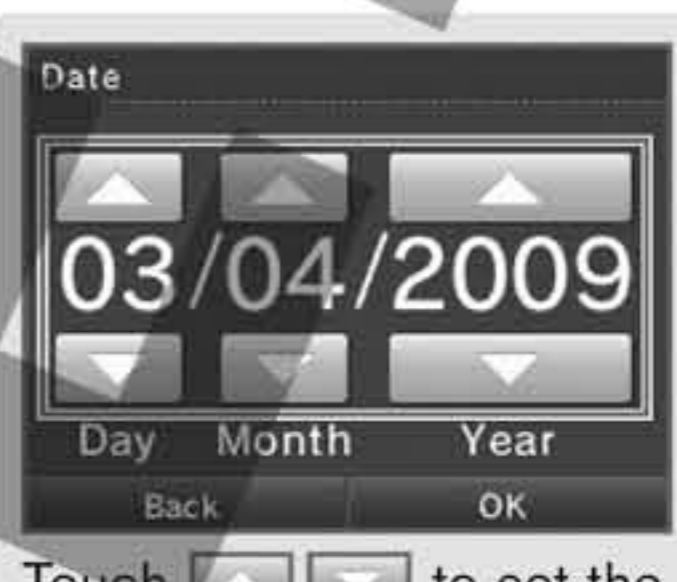

Touch **▲ ▼** to set the date.

Touch **OK**

### 5 Set the time



Touch **▲ ▼** to set the time.

Touch **OK**

### 6 Enter a name



Touch the keyboard and enter a name.

Touch **OK**

### 7 Enter a message



Touch the keyboard and enter a message.

**Note:** You can add a message containing anything you like. Why not try entering a greeting or a brief self-introduction?

Touch **OK**

### 8 Set your birthday



Touch **▲ ▼** to set your birthday.

Touch **OK**

### 9 Choose a colour

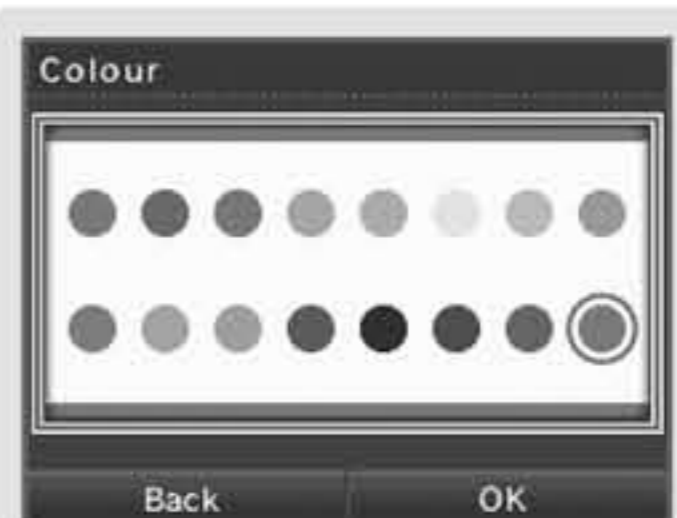

Touch a colour of your choice.

**Note:** This colour will be used in various places, such as the Nintendo DSi Menu.

Touch **OK**

### 10 Configure Parental Controls



Begin configuring the Parental Controls.  
→ Nintendo DSi Operations Manual – Applications and Settings – System Settings: Parental Controls

Your System Settings have now been configured. The system will restart automatically.

Now you're ready to take some photos!

## 2. Take some photos!



After the system restarts, you'll be asked if you want to take a photo. Touch OK and try taking some photos!

### 1 Touch each screen as shown

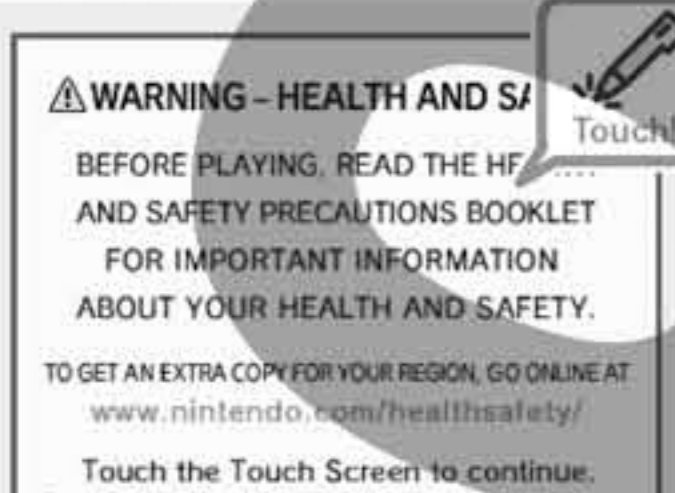

### 2 Touch **Capture**

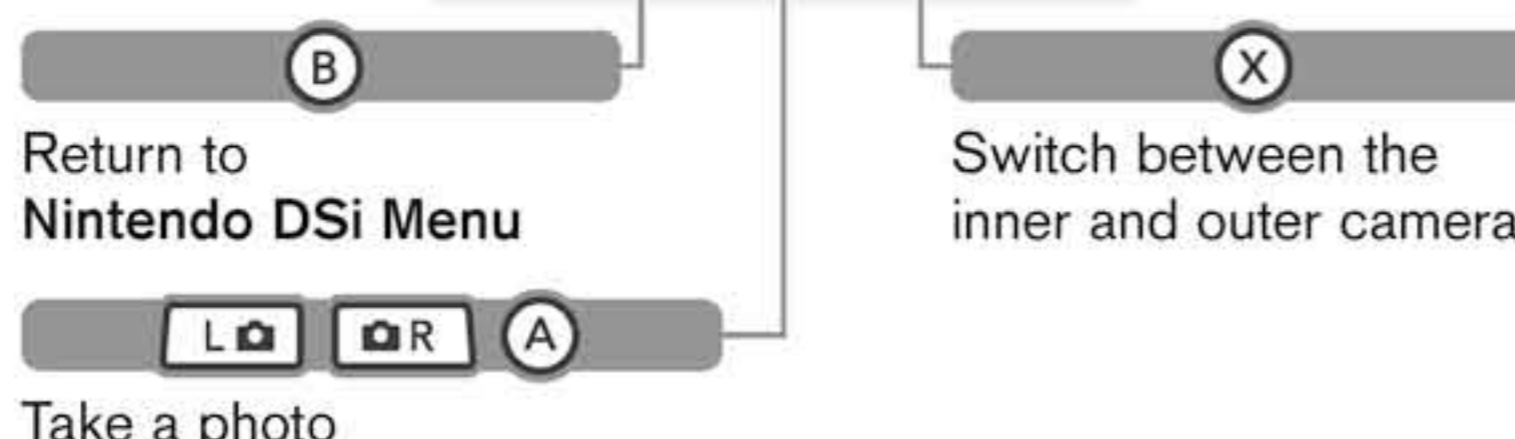

**Note:** The same actions can be done by pressing the buttons shown above.

### 3 Touch each screen as shown



### 4 Finish taking photos



**Note:** You can also take photos from within the Nintendo DSi Menu by pressing **L** or **R**.

→ Nintendo DSi Operations Manual – Applications and Settings – Nintendo DSi Menu: Camera Mode

### 3. Load software!



With Nintendo DSi you can use the following: Nintendo DS Cards, Nintendo DSi compatible Cards and Nintendo DSi Cards. Follow the steps below to load the software.

#### 1 Insert the software

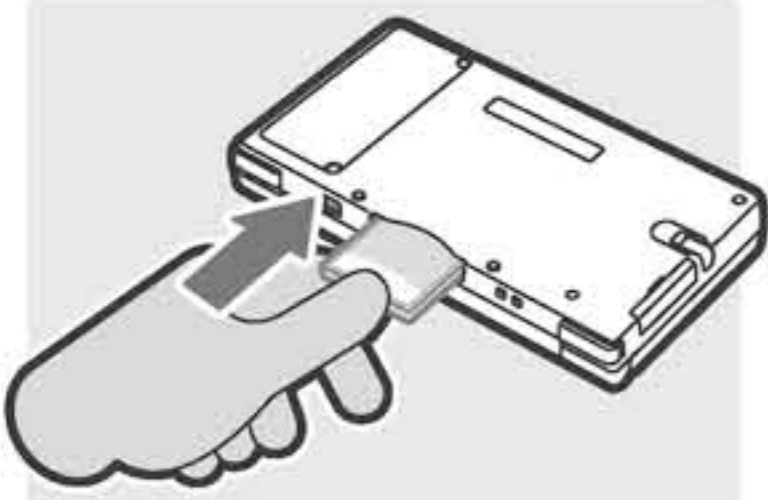

The label should face towards the bottom of the system.

#### 2 Turn the power on

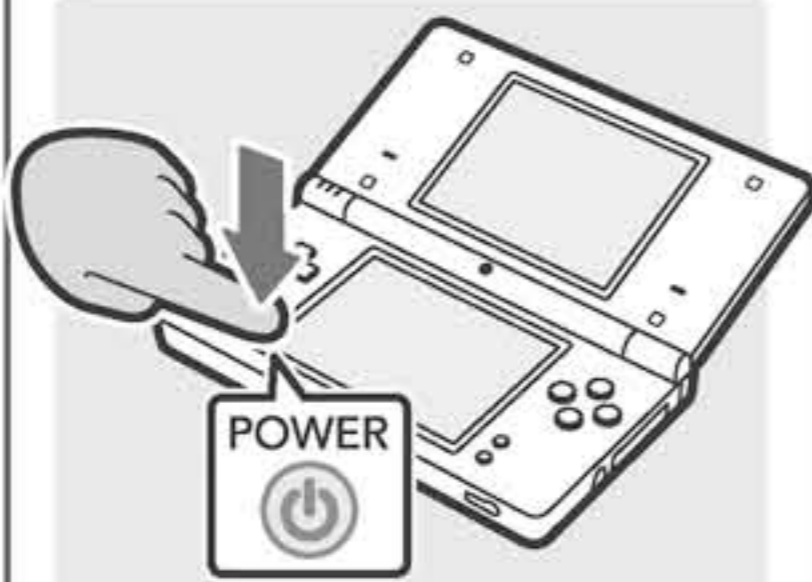

Press the POWER Button

#### 3 Touch the Touch Screen

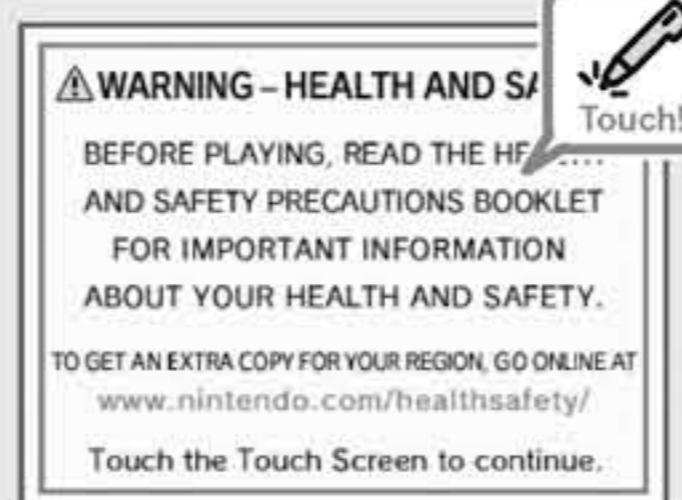

Touch the Touch Screen

#### 4 Start the software



Touch the icon

For further instructions, refer to the Instruction Booklet for the software you are using.

**Note:** This screenshot shows "The Legend of Zelda: Phantom Hourglass", a title for Nintendo DS systems.

### 4. Introducing the built-in software



#### The six types of built-in software

The Nintendo DSi system comes with six built-in software applications. To start an application, touch the corresponding icon in the Nintendo DSi Menu.



Nintendo DSi Menu

**System Settings**  
Adjust date and time settings, and calibrate the Touch Screen.  
→ Nintendo DSi Operations Manual – Applications and Settings – System Settings

**DS Download Play**  
Download demo versions of titles or go head-to-head with others using wireless game play modes.  
→ Nintendo DSi Operations Manual – Applications and Settings – DS Download Play

**PictoChat™**  
Send and receive wireless messages and pictures from other Nintendo DS system users (Nintendo DS, Nintendo DS Lite and Nintendo DSi).  
→ Nintendo DSi Operations Manual – Applications and Settings – PictoChat

**Nintendo DSi Camera**  
Have fun with photos you take using the built-in cameras.  
→ Nintendo DSi Operations Manual – Applications and Settings – Nintendo DSi Camera

**Nintendo DSi Sound**  
Have fun playing music files and recording your voice.  
→ Nintendo DSi Operations Manual – Applications and Settings – Nintendo DSi Sound

**Nintendo DSi Shop**  
Purchase titles using Nintendo DSi Shop.  
**Note:** This application requires internet access.  
→ Nintendo DSi Operations Manual – Applications and Settings – Nintendo DSi Shop

#### Play with photos!

With Nintendo DSi Camera, you can take all sorts of fun photos!

For example...

...touch to distort photos...



...add graffiti...

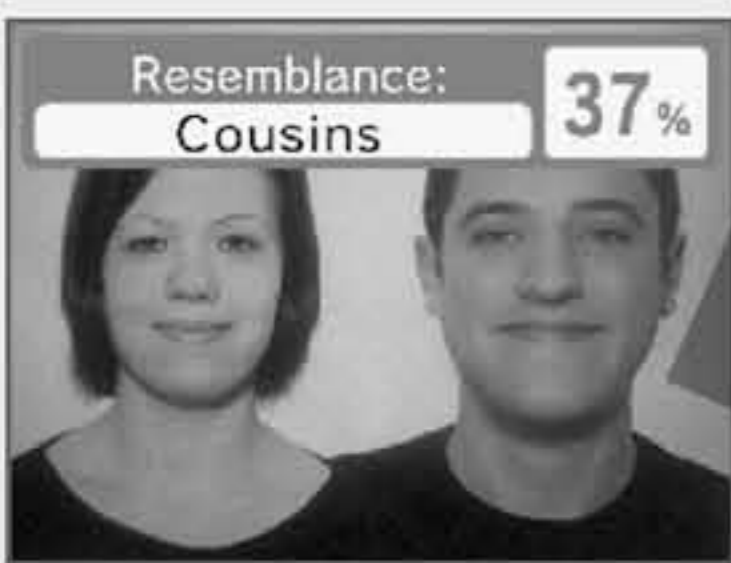
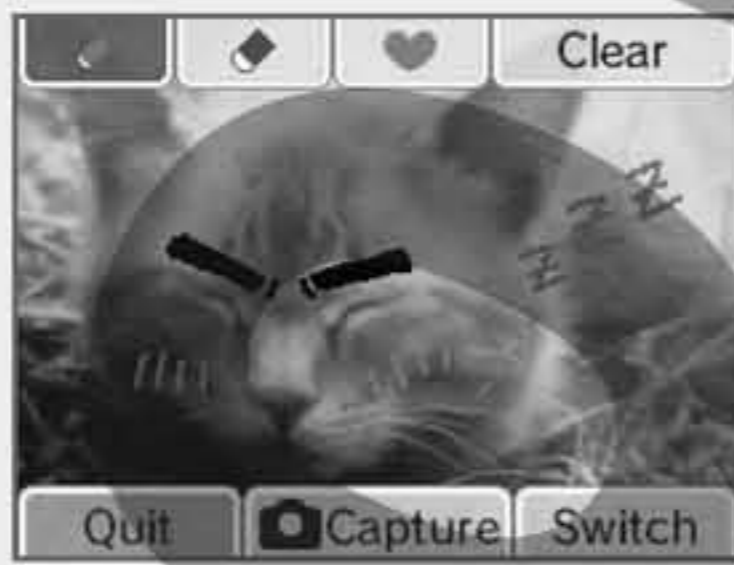

...see how alike you are...



...merge your faces together!

#### Play with sounds!

With Nintendo DSi Sound, you can have fun with music files and your recorded voice!

For example...

...take music you know well...



...make it sound like music from an old-fashioned radio...



...or make it sound like music from a Nintendo Entertainment System!



Record your voice, and...

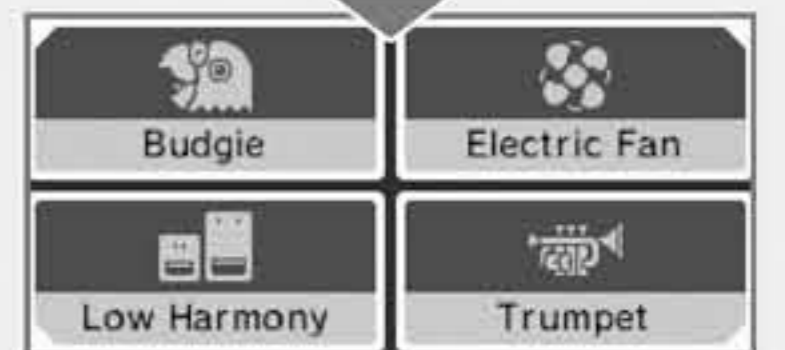

...have fun with the pitch and speed!

### If the Touch Screen is unresponsive...



You may need to calibrate the Touch Screen if you feel it is not responding properly, or if you feel that your actions are not being reflected accordingly on the screen.

**Note:** If you have applied a commercially-available protective sheet to your Touch Screen, make sure it has been applied correctly before attempting to calibrate the Touch Screen.

#### 1 Touch



Nintendo DSi Menu

#### 2 Touch



System Settings

#### 3 Follow the on-screen directions

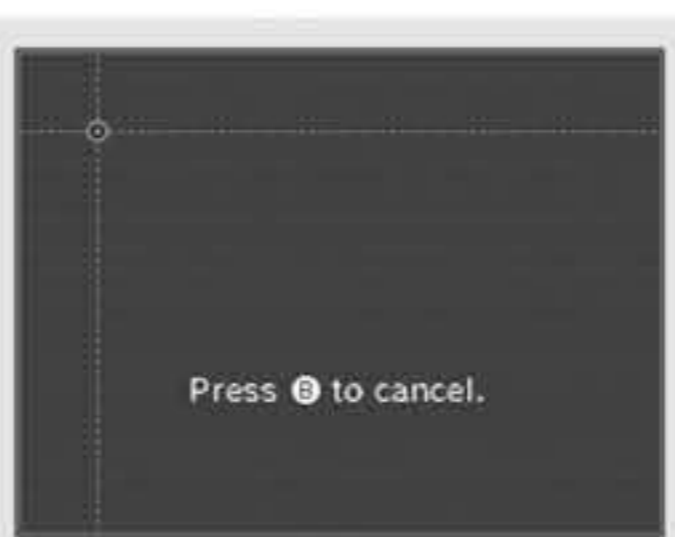

Touch Screen Calibration Screen

#### If you're unable to operate the Touch Screen properly...

You can start up the system at the **Touch Screen Calibration Screen** by following the procedure below.

- 1 While holding down the L Button, R Button and START...

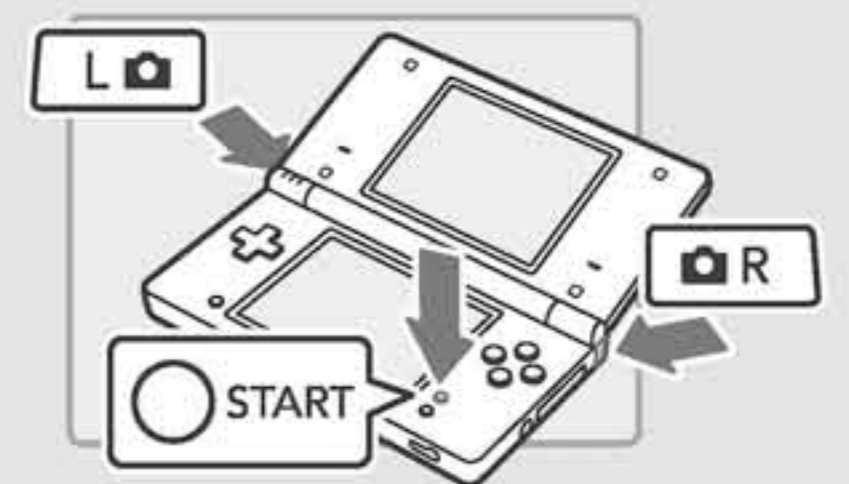

- 2 ...press the POWER Button.

